

# Invisacta

The **wide** range  
of **concealed hinges**



中意信诚 - 高端进口五金

购买咨询：13910114747 (微信同号)

官网链接：[www.china-era.com](http://www.china-era.com)

# **WARNING!**

## **INSTALLATION DEVICE PROTECTED BY PATENT**

Only (by) using **INVISACTA**, you can avoid to **cut the cover strips** (in green), thanks to the only 21 mm depth of the hull on the frame side (fig. 1), and **at the same time** install the hinge in the middle of the door thickness (fig. 2) **making the door become both left and right, that means reversible** (fig. 3).



**There are unoriginal INVISACTA hinges** on the market; that don't have the license to use OTLAV patent.

Producing doors as shown herein, with unoriginal **INVISACTA** hinges, **means to make an injury to OTLAV patent rights**, injury which is punishable both civilly and criminally.

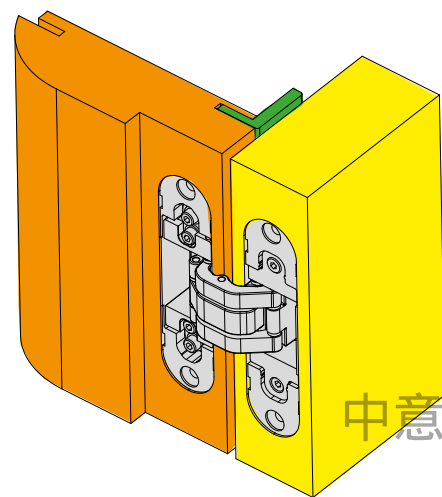

**European Patent  
EP-B-2719851  
16/04/2014**

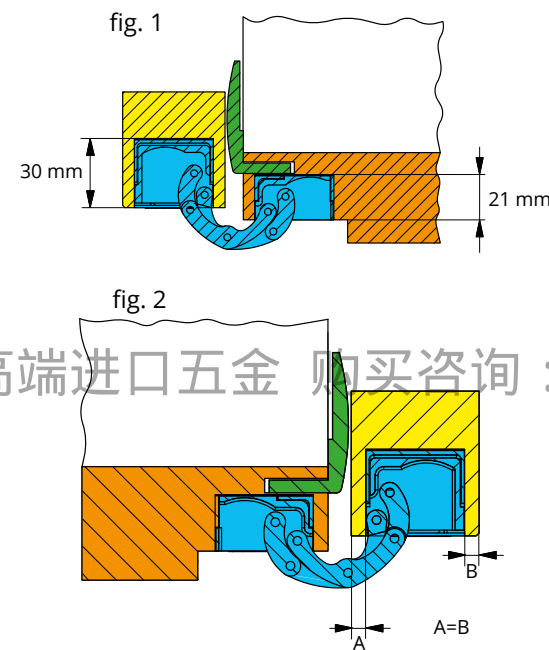

Since **1956**, thanks to our hinges, more than **1,000,000,000** doors are opening **in 80 countries** all over the world.

中意信诚-高端进口五金 购买咨询：13910114747（微信同号） www.china-era.co

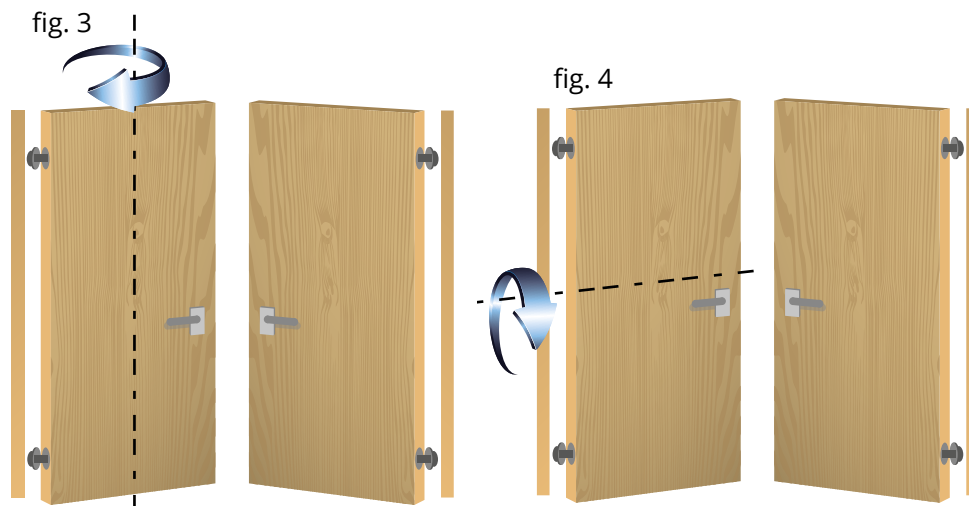

INVISACTA hinge is reversible, which makes the door reversible also vertically (fig. 4).



# COMPANY

OTLAV S.p.A produces and sells hinges for doors and windows and other accessories for frames.

**Founded in 1956** by entrepreneur Angelo Padovan, Otlav has produced **more than 2,2 billion of hinges**.

Thanks to almost 100 filed patents, Otlav ensures high quality standards and is present with its wide range of products in more than **80 countries worldwide**. OTLAV new factory was inaugurated in 2007, in Via Angelo Padovan 2 in Santa Lucia di Piave (TV), in an area of 45,000 square meters, 19,500 of which are covered.

Following the opening of the first office in March 1956, OTLAV has nowadays found its perfect location to face the challenges of the new millennium. "OAMH" "Otlav Automatic Material Handling" is a project developed after five years of research and studies all around the world; a technological jewel created by designing at first the best logistical location, and then a subsequent lay out, and eventually the container to cover these structures: an unmistakable technological masterpiece, which is 20 meters high.

Rationalization of space, optimization of logistics and integrated use of automation: all of these account for respectively the flow or transportation of materials and the streaming of information. The goal is to cut costs by making the produced hinges increasingly competitive with an unparalleled level of quality.

## OTLAV group companies



In 1990 Otlav creates Myrtus in Maniago (PN), Friuli. The company is specialized in galvanic treatments.



Founded 2002 in Romania is focused on some high-tech producing processes.

# QUALITY

As required by European regulations and by Regulation (EU) No. 305/2011 all OTLAV hinges are subjected to stringent resistance tests to check performance both during the design phase and regularly during manufacturing.

The I.U.S. (Intensive Use Simulator) is the testing system used in the OTLAV Test Laboratories.

### EC Certificates and Performance Declarations

Tests on the hinges are also carried out at external bodies able to certify that the company manufactures according to rigid, systematically monitored production plans and that the products pass the tests envisaged by the standard UNI EN 1935/2004: they are thereby able to issue, if needed, the CE certificate or certify the data provided by OTLAV in the "performance declarations".



View of the OTLAV test laboratories I.U.S. (Intensive Use Simulator)



# INVISACTA PLUS+

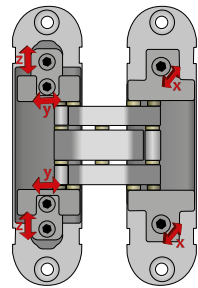
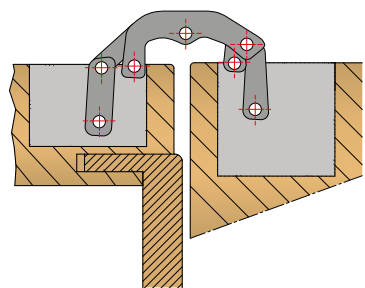

## 7 JUNCTION FULCRUMS

No sliding wear

**7 fulcrum points allow little friction, good flow, solidity and high loading capacity;** no contact between the different bearing units thanks to nylon bushes with high friction resistance.

The clamping screws, placed in the outer casings, are not used for hinge adjustment, therefore they **remain stable for a long time.**

IN570, IN310, IN303, IN300, IN305, IN230 and IN235 models

## 3 ADJUSTMENTS

With only one hex spanner

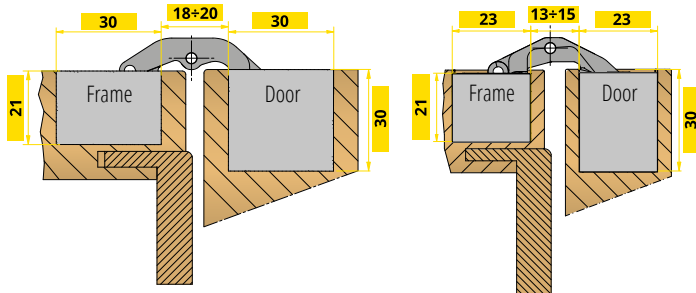

## MINIMAL DIMENSIONS

Slot on frame side: 21 mm

**A 21 mm depth slot on the frame side** makes it unique and enables its perfect integration in reduced spaces. No need to cut the architrave which can be flush mounted.

IN303, IN300, IN305, IN301, IN230, IN232 and IN235 models



## REVERSIBILITY

Invisacta hinges are all reversible

The hinge if mounted in the center of the door thickness\*, allows the reversibility of the door, thus enabling the **optimization of the stock and logistics at installation.**

\* IN570, IN303, IN300, IN305 and IN301 models

## COMPATIBILITY

Same millings, different hinges.

中意信诚-高端进口五金 购买咨询：13910114747（微信同号）www.china-era.co

### IN230

Doors up to 60 kg.



### IN235

Doors up to 40 kg.



### IN232

Doors up to 30 kg.



### AI230

Door alignment device



Millings 23x120 mmh

## KIND OF FINISHING

The wide range of colours allows finding the right correspondence with any finish of the doors



Satinized Silver Plated



Zinc Plated



Satinized Nickel Plated



Bronze Plated



Bronze Plastified

### IN303

Doors up to 80 kg.



### IN300

Doors up to 60 kg.



### IN305

Doors up to 40 kg.



### CI335

Doors up to 40 kg.



### AI300

Door alignment device

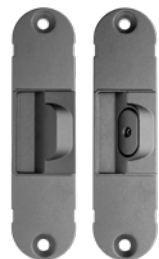

Millings 30x120 mmh



Polished Gold



Matt Gold



Chrome Plated



White Matt RAL 9016



Matt Black Plastified

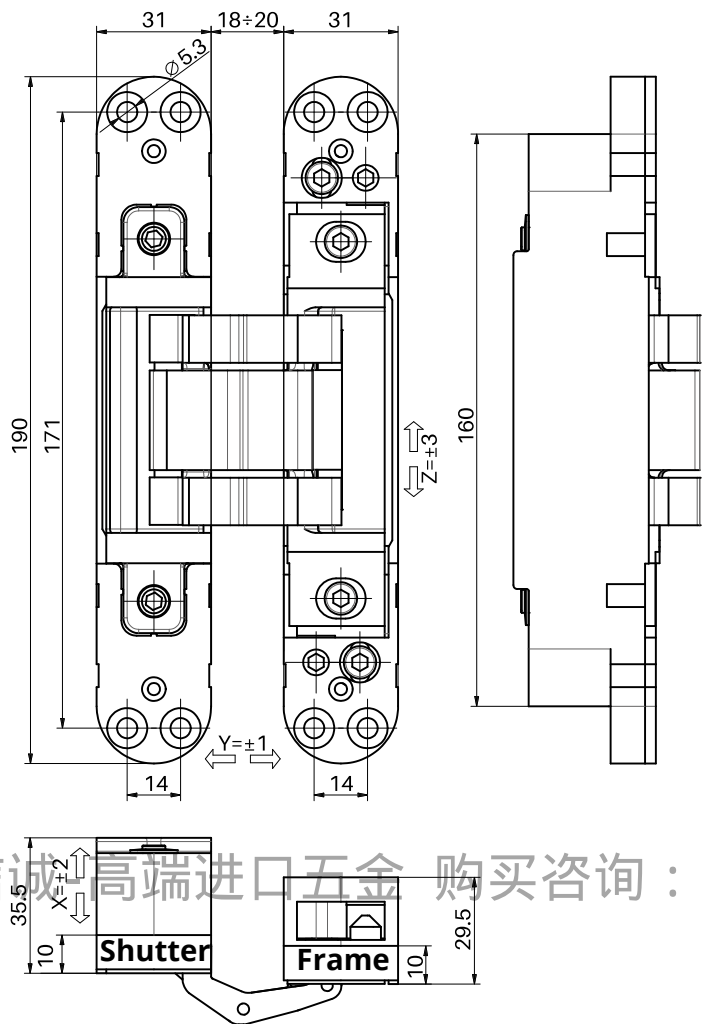

Technical data

Capacity*	120 Kg.
Hinge height	190 mm
Width shutter side	31 mm
Width frame side	31 mm
Depth shutter side	35,5 mm
Depth frame side	29,5 mm
Door opening angle	180°

Side adjustment	± 1,5 mm
Height adjustment	± 3 mm
Depth adjustment	± 1 mm

\* Tested with 90x210 cm doors - For more information on the number of hinges to be used according to the weight and dimension of the door, please see the loading charts available on the website [www.otlav.it](http://www.otlav.it).

Technical features

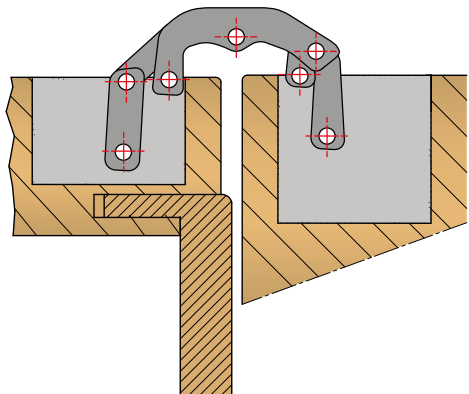

- Movement on **7 junction fulcrums** equipped with bearing in plastic HT with high resistance and long life.
- Equipped with **3-way adjustments** that can be settled by means of just one 4 mm hex-spanner. Once installed, the door has natural sinking, Invisacta hinge allows to set the door back to the start position.
- **The hinge can be fitted with door closing devices.**
- Outer casings protect the inner junction fulcrums against rubble coming from door installation works.
- The clamping screws, placed in the outer casings, are not used for hinge adjustment, therefore they remain stable for a long time.
- **CE certified** - according European Assessment Document 020001-01-0405.
- The hinge meets the **anti-burglary** criteria according European Assessment Document 020001-01-0405.
- **Fireproof certified 90'** according UNI-EN 1634-1.
- Reversible
- Material of levers: aluminum.
- Material of casing: zamak.
- **Caps** available to conceal the screws.

Finishing



IN310190V703  
Satinized Silver Plated



IN310190VN03  
Satinized Nickel Plated



IN310190N03  
Matt Black Plastified



IN310190P03  
White Matt RAL 9016

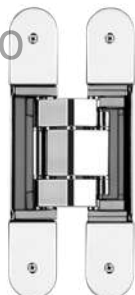

IN310190VD03  
Polished Crome



IN310190VO03  
Polished Gold

OTHER KIND OF FINISHING  
AVAILABLE ON REQUEST

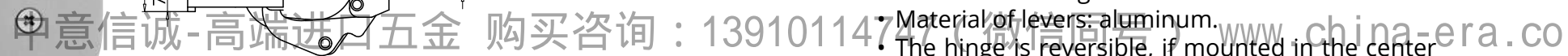

Capacity*	60 Kg.
Hinge height	130 mm
Width shutter side	32 mm
Width frame side	25 mm
Depth shutter side	53 mm
Depth frame side	31 mm
Door opening angle	180°
Side adjustment	± 1.5 mm
Height adjustment	± 2 mm
Depth adjustment	± 1 mm

## Technical features

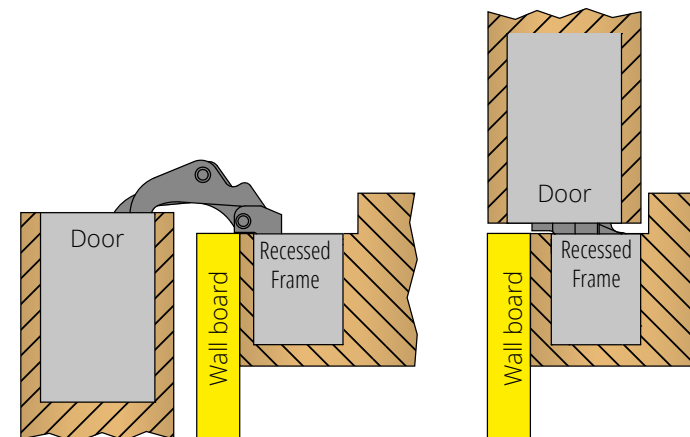

- The hinge is suitable to be installed on doors with **recessed frame** to accept application of wall board to match the door.
- Suitable for installation on panels with **thickness 40 and 44 mm**.
- The hinge can be installed with mounted gasket up to 6 mm thick.
- Allows the application of very thick architraves or coating panels: up to 18 mm.
- Material of casing: zamak.
- Material of levers: aluminum.
- The hinge is reversible, if mounted in the center of the door thickness, allows the **reversibility of the door**, thus enabling the optimization of the stock and logistics at installation.
- Movement on **7 junction fulcrums** equipped with bearing in plastic HT with high resistance and long life.
- Equipped with **3-way adjustments** that can be settled by means of just one hex-spanner. Once installed, the door has natural sinking, Invisacta hinge allows to set the door back to the start position.
- Outer casings protect the inner junction fulcrums against rubble coming from door installation works.
- The clamping screws, placed in the outer casings, are not used for hinge adjustment, therefore they remain stable for a long time.
- Equipped with **caps** to conceal the screws.

**IN570130VN03**  
Satinized Nickel Plated

**OTHER KIND OF FINISHING  
AVAILABLE ON REQUEST**



# IN303120 3D invisible hinge for 80 kg. doors

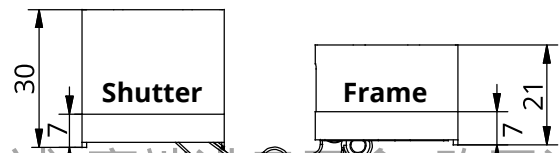
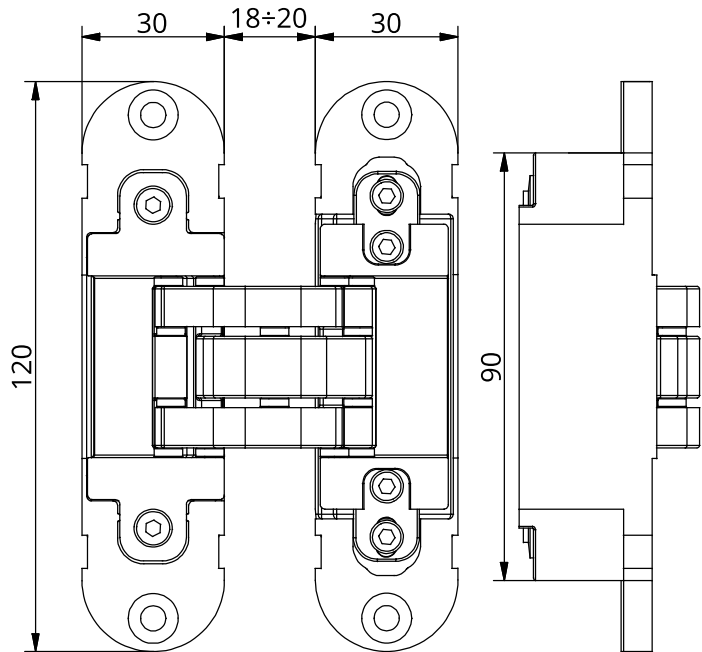

## Technical data

Capacity*	80 Kg.
Hinge height	120 mm
Width shutter side	30 mm
Width frame side	30 mm
Depth shutter side	30 mm
Depth frame side	21 mm
Door opening angle	180°
Side adjustment	± 1 mm
Height adjustment	± 2 mm
Depth adjustment	± 1 mm

\* Tested with 90x210 cm doors - For more information on the number of hinges to be used according to the weight and dimension of the door, please see the loading charts available on the website [www.otlav.it](http://www.otlav.it).

**PATENTED**

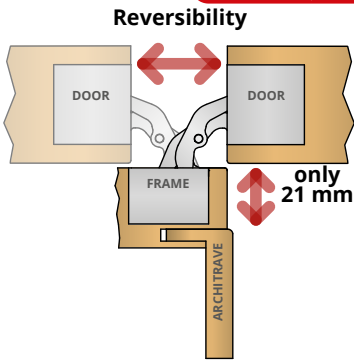

IN303 hinge allows at the same time:  
**Reversibility of the door** with hinge mounted in the center of the door thickness.  
**No need to cut the architrave** thanks to only 21 mm of frame slot depth.  
Patented EP-B2719851.

## Technical features

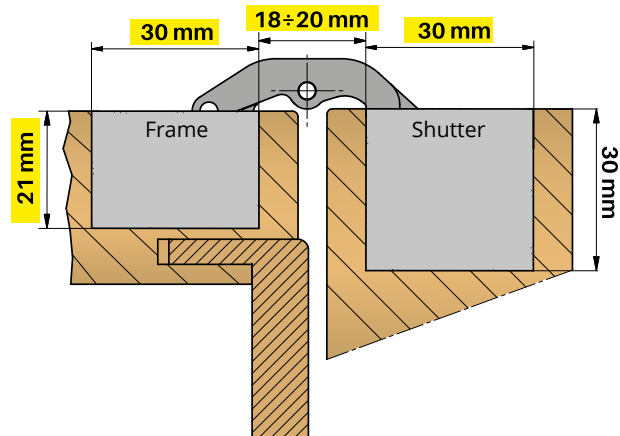

- A 21 mm depth slot on the frame side makes it unique and enables its **perfect integration in reduced spaces**. No need to cut the architrave which can be flush mounted.
- The hinge is reversible, if mounted in the center of the door thickness, allows the **reversibility of the door**, thus enabling the optimization of the stock and logistics at installation.
- Movement on **7 junction fulcrums** equipped with bearing in plastic HT with high resistance and long life.
- Equipped with **3-way adjustments** that can be settled by means of just one 3 mm hex-spanner. Once installed, the door has natural sinking, Invisacta hinge allows to set the door back to the start position.
- Outer casings protect the inner junction fulcrums against rubble coming from door installation works.
- The clamping screws, placed in the outer casings, are not used for hinge adjustment, therefore they remain stable for a long time.
- **The hinge can be fitted with door closing devices.**
- Material of levers: aluminum.
- Material of casing: zamak.
- **CE certified** - according European Assessment Document 020001-01-0405
- **Fireproof certified 45'** according UNI-EN 1634-1
- **Aluminum caps** available to conceal the screws.

## Finishing



Hinge **IN303120V702**  
Caps **GC300010J102**  
Satinized Silver Plated



Hinge **IN303120VN02**  
Caps **GC300010J205**  
Satinized Nickel Plated



Hinge **IN303120VO02**  
Caps **GC300010JO05**  
Polished Gold



Hinge **IN303120VD02**  
Caps **GC300010VD02**  
Polished Chrome

**OTHER KIND OF FINISHING  
AVAILABLE ON REQUEST**

# IN300120 3D hinge for 60 kg. doors

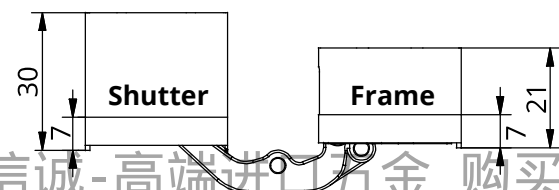
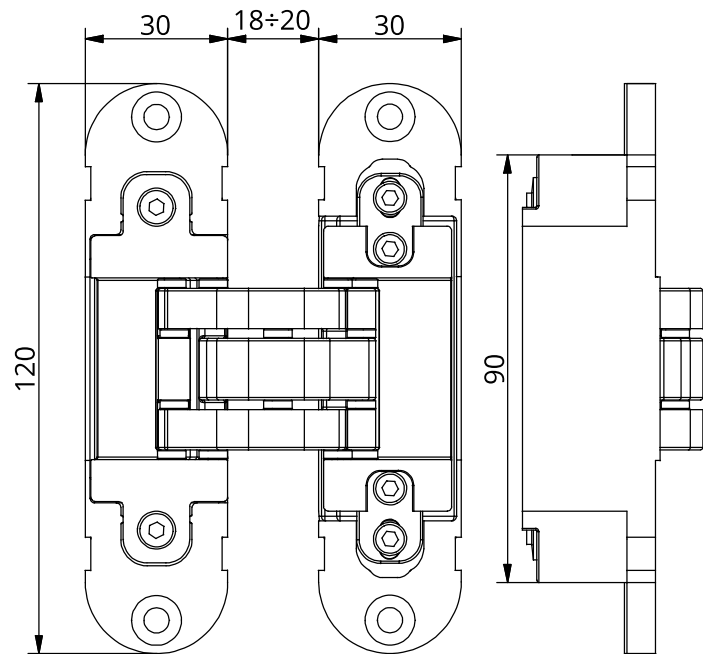

## Technical data

Capacity*	60 Kg.
Hinge height	120 mm
Width shutter side	30 mm
Width frame side	30 mm
Depth shutter side	30 mm
Depth frame side	21 mm
Door opening angle	180°
Side adjustment	± 1 mm
Height adjustment	± 2 mm
Depth adjustment	± 1 mm

\* Tested with 90x210 cm doors - For more information on the number of hinges to be used according to the weight and dimension of the door, please see the loading charts available on the website [www.otlav.it](http://www.otlav.it).

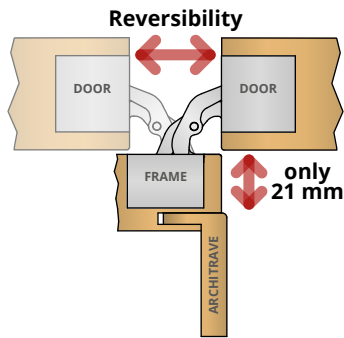

IN300 hinge allows at the same time:  
**Reversibility of the door** with hinge mounted in the center of the door thickness.  
**No need to cut the architrave** thanks to only 21 mm of frame slot depth. Patented EP-B2719851.

## Technical features

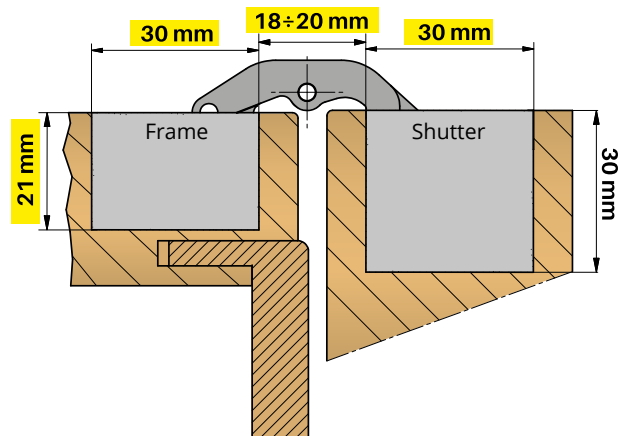

- A 21 mm depth slot on the frame side makes it unique and enables its **perfect integration in reduced spaces**. No need to cut the architrave which can be flush mounted.
- The hinge is reversible, if mounted in the center of the door thickness, allows the **reversibility of the door**, thus enabling the optimization of the stock and logistics at installation.
- Movement on **7 junction fulcrums** equipped with bearing in plastic HT with high resistance and long life.
- Equipped with **3-way adjustments** that can be settled by means of just one 3 mm hex-spanner. Once installed, the door has natural sinking, Invisacta hinge allows to set the door back to the start position.
- Material of hinge: zamak.
- **The hinge can be fitted with door closing devices.**
- Outer casings protect the inner junction fulcrums against rubble coming from door installation works.
- The clamping screws, placed in the outer casings, are not used for hinge adjustment, therefore they remain stable for a long time.
- Material of hinge: ZAMAK.
- **CE certified** - according European Assessment Document 020001-01-0405
- **Fireproof certified 30'** according UNI-EN 1634-2.
- **Aluminum caps** available to conceal the screws.

## Finishing



Hinge **IN300120V702**  
Caps **GC300010J102**  
Satinized Silver Plated



Hinge **IN300120VN02**  
Caps **GC300010J205**  
Satinized Nickel Plated



Hinge **IN3001209P02**  
Caps **GC3000109P02**  
White Matt RAL 9016



Hinge **IN300120H004**  
Caps **GC300010J102**  
Zinc Plated



Hinge **IN300120BO02**  
Caps **GC3000109R02**  
Bronze Plated



Hinge **IN300120VO02**  
Caps **GC300010JO05**  
Polished Gold



Hinge **IN3001209N02**  
Caps **GC3000109N02**  
Matt Black Plastified

**OTHER KIND OF FINISHING  
AVAILABLE ON REQUEST**



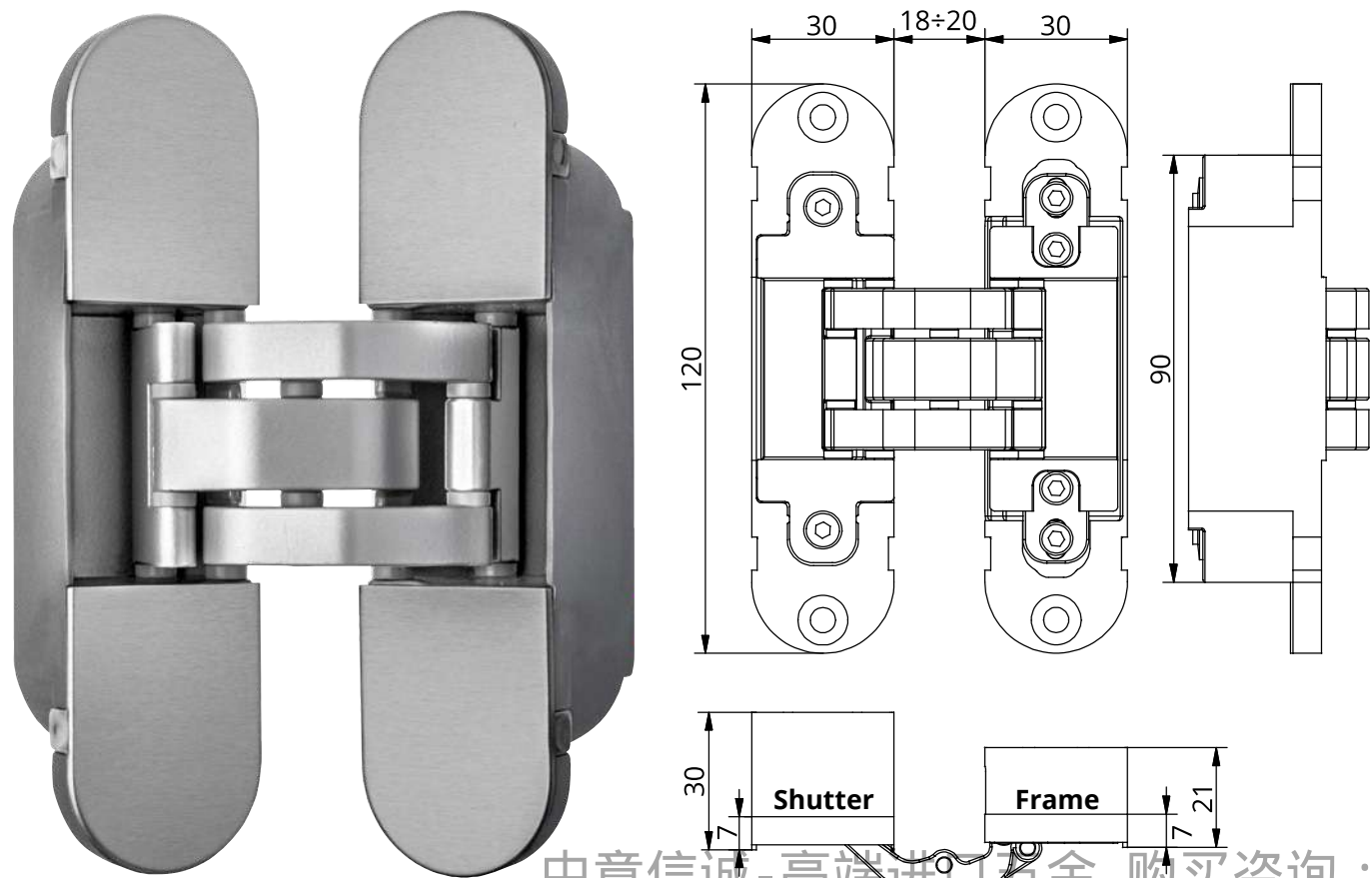

中意信诚-高端进口五金 购买咨询：13910114747 (微信同号) www.china-era.co

Technical data

Capacity*	40 Kg.
Hinge height	120 mm
Width shutter side	30 mm
Width frame side	30 mm
Depth shutter side	30 mm
Depth frame side	21 mm
Door opening angle	180°
Side adjustment	± 1 mm
Height adjustment	± 2 mm
Depth adjustment	± 1 mm

\* Tested with 90x210 cm doors - For more information on the number of hinges to be used according to the weight and dimension of the door, please see the loading charts available on the website [www.otlav.it](http://www.otlav.it).

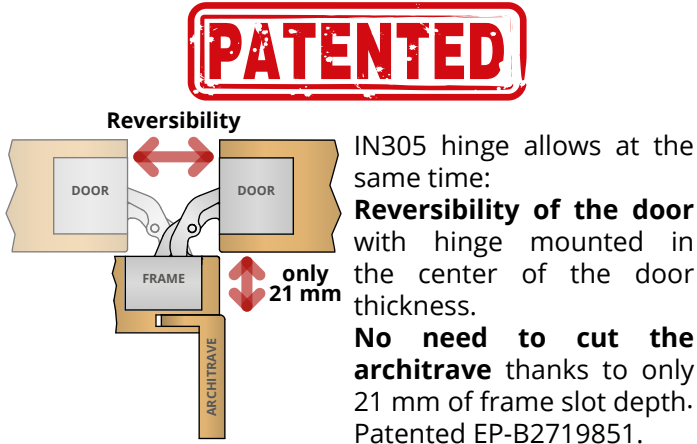

Technical features

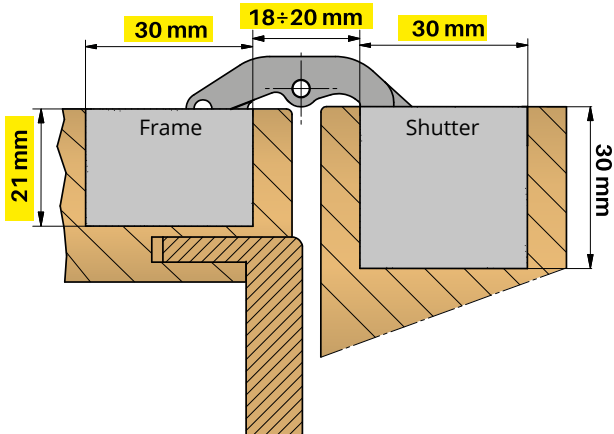

- A 21 mm depth slot on the frame side makes it unique and enables its **perfect integration in reduced spaces**. No need to cut the architrave which can be flush mounted.
- The hinge is reversible, if mounted in the center of the door thickness, allows the **reversibility of the door**, thus enabling the optimization of the stock and logistics at installation.
- Movement on **7 junction fulcrums** equipped with bearing in plastic HT with high resistance and long life.
- Equipped with **3-way adjustments** that can be settled by means of just one 3 mm hex-spanner. Once installed, the door has natural sinking, Invisacta hinge allows to set the door back to the start position.
- Material of hinge: ZAMAK.
- Material of casing: thermoplastic polymer.
- Outer casings protect the inner junction fulcrums against rubble coming from door installation works.
- The clamping screws, placed in the outer casings, are not used for hinge adjustment, therefore they remain stable for a long time.
- **Aluminum caps** available to conceal the screws.

Finishing



Hinge **IN305120V702**  
Caps **GC300010J102**  
Satinized Silver Plated



Hinge **IN305120VN02**  
Caps **GC300010J205**  
Satinized Nickel Plated



Hinge **IN305120H002**  
Caps **GC300010J102**  
Zinc Plated

**OTHER KIND OF FINISHING  
AVAILABLE ON REQUEST**

# IN230120 3D invisible hinge for 60 kg. doors

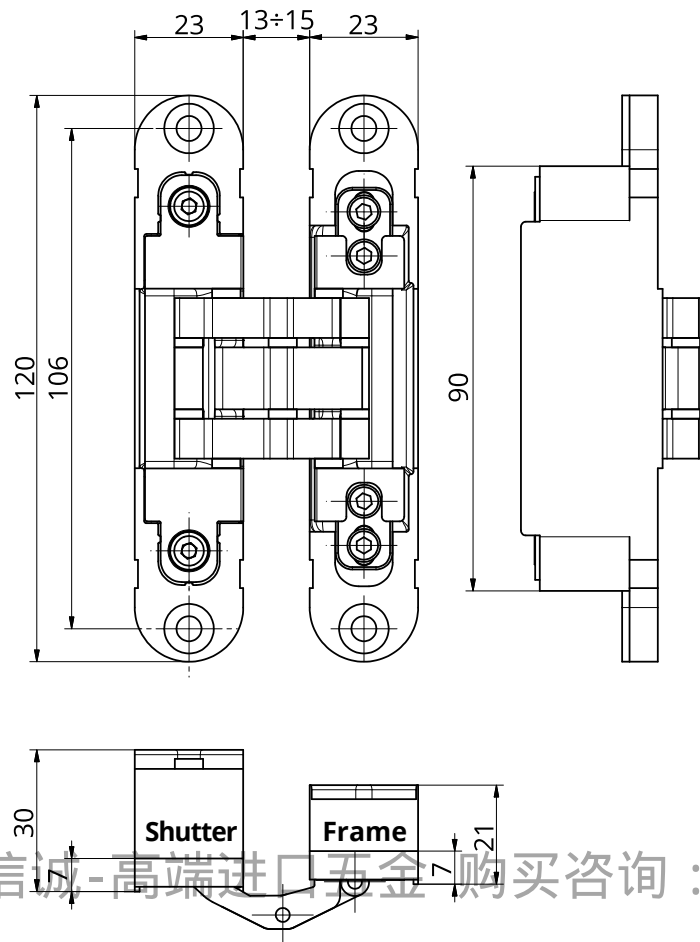

## Technical data

Capacity*	60 Kg.
Hinge height	120 mm
Width shutter side	23 mm
Width frame side	23 mm
Depth shutter side	30 mm
Depth frame side	21 mm
Door opening angle	180°
Side adjustment	± 1 mm
Height adjustment	± 2 mm
Depth adjustment	± 1 mm

\* Tested with 90x210 cm doors - For more information on the number of hinges to be used according to the weight and dimension of the door, please see the loading charts available on the website [www.otlav.it](http://www.otlav.it).

## Technical features

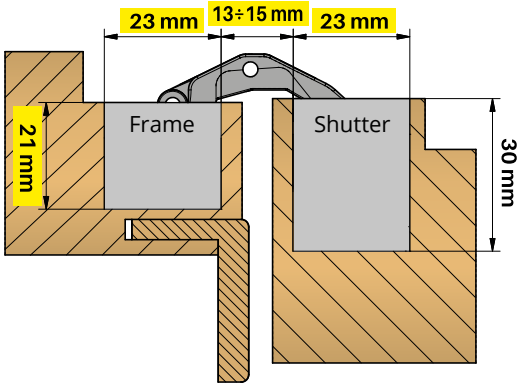

- A **21 mm depth slot** on the frame side makes it unique and enables its perfect integration in reduced spaces. No need to cut the architrave which can be flush mounted.
- Movement on **7 junction fulcrums** equipped with bearing in plastic HT with high resistance and long life.
- Equipped with **3-way adjustments** that can be settled by means of just one 3 mm hex-spanner. Once installed, the door has natural sinking, Invisacta hinge allows to set the door back to the start position.
- The hinge is reversible.
- **The hinge can be fitted with door closing devices.**
- Outer casings protect the inner junction fulcrums against rubble coming from door installation works.
- The clamping screws, placed in the outer casings, are not used for hinge adjustment, therefore they remain stable for a long time.
- Material of hinge: ZAMAK.
- **CE certified** - according European Assessment Document 020001-01-0405
- **Fireproof certified 30'** according UNI-EN 1634-2
- **Aluminum caps** available to conceal the screws.

## Finishing



Hinge **IN230120V702**  
Caps **GC230010J102**  
Satinized Silver Plated



Hinge **IN230120H004**  
Caps **GC230010J102**  
Zinc Plated



Hinge **IN230120VN02**  
Caps **GC230010J202**  
Satinized Nickel Plated



Hinge **IN230120BO02**  
Caps **GC230010R02**  
Bronze Plated



Hinge **IN2301209P02**  
Caps **GC230010P02**  
White Matt RAL 9016



Hinge **IN230120VO02**  
Caps **GC230010J005**  
Polished Gold



Hinge **IN2301209N02**  
Caps **GC2300109N02**  
Matt Black Plastified

**OTHER KIND OF FINISHING  
AVAILABLE ON REQUEST**



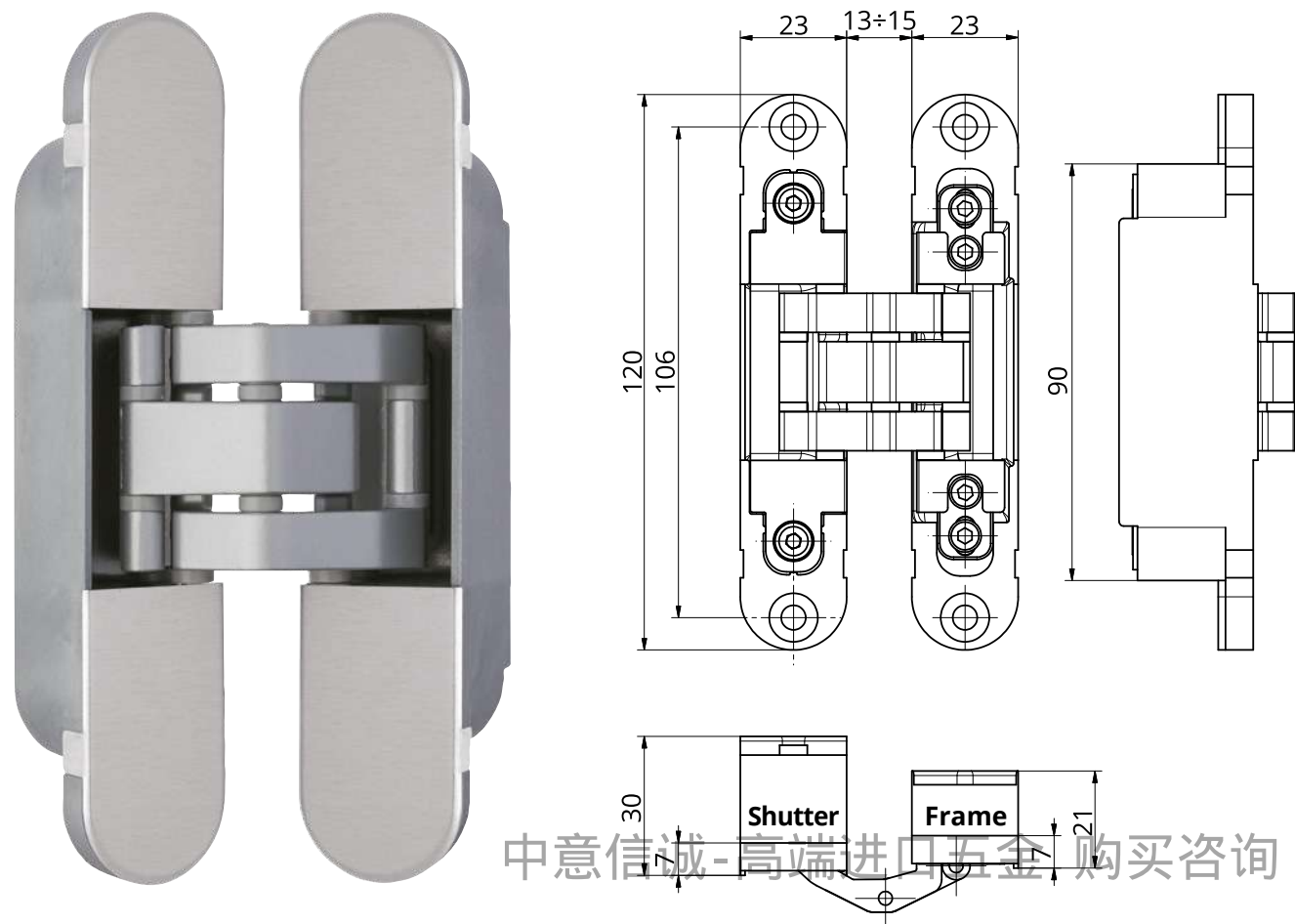

Technical data

Capacity*	40 Kg.
Hinge height	120 mm
Width shutter side	23 mm
Width frame side	23 mm
Depth shutter side	30 mm
Depth frame side	21 mm
Door opening angle	180°
Side adjustment	± 1 mm
Height adjustment	± 2 mm
Depth adjustment	± 1 mm

\* Tested with 90x210 cm doors - For more information on the number of hinges to be used according to the weight and dimension of the door, please see the loading charts available on the website [www.otlav.it](http://www.otlav.it).

Technical features

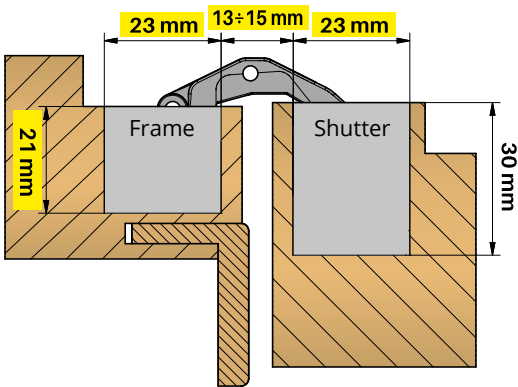

- A **21 mm depth slot** on the frame side makes it unique and enables its perfect integration in reduced spaces. No need to cut the architrave which can be flush mounted.
- Movement on **7 junction fulcrums** equipped with bearing in plastic HT with high resistance and long life.
- Equipped with **3-way adjustments** that can be settled by means of just one 3 mm hex-spanner. Once installed, the door has natural sinking, Invisacta hinge allows to set the door back to the start position.
- Material of hinge: ZAMAK.
- Material of casing: thermoplastic polymer.
- The hinge is reversible.
- Outer casings protect the inner junction fulcrums against rubble coming from door installation works.
- The clamping screws, placed in the outer casings, are not used for hinge adjustment, therefore they remain stable for a long time.
- **Aluminum caps** available to conceal the screws.

Finishing



OTHER KIND OF FINISHING  
AVAILABLE ON REQUEST

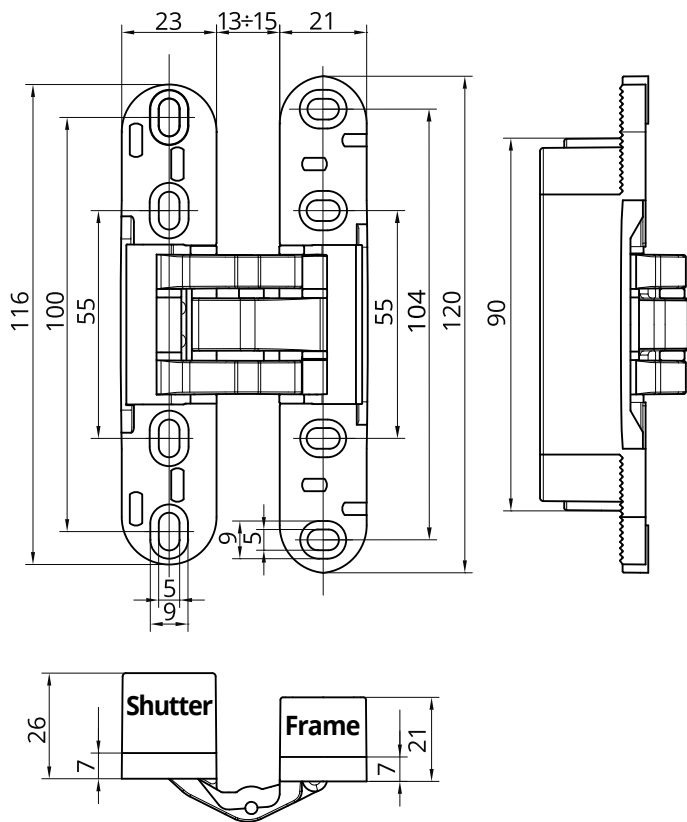
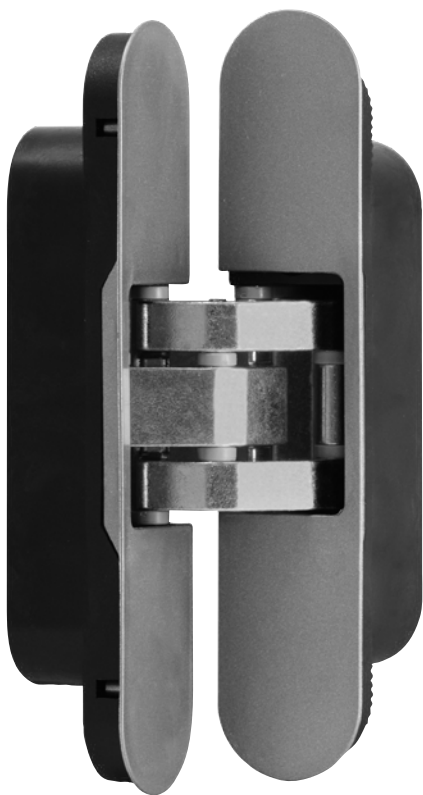

Technical data

Capacity*	30 Kg.
Depth shutter side	26 mm
Depth frame side	21 mm
Door opening angle	180°
Height adjustment	± 2 mm
Depth adjustment	± 1 mm

\* Tested with 90x210 cm doors - For more information on the number of hinges to be used according to the weight and dimension of the door, please see the loading charts available on the website [www.otlav.it](http://www.otlav.it).

Technical features

- A 21 mm depth slot on the frame side makes it unique and enables its perfect integration in reduced spaces. No need to cut the architrave which can be flush mounted.
- Material of levers: zamak.
- Material of casing: thermoplastic polymer.
- Equipped with caps to conceal the screws.
- The hinge can be fitted right and left.
- Movement on 7 junction fulcrums equipped with bearing in plastic HT with high resistance and long life.
- Equipped with height and depth adjustments.
- Compatible with millings of IN230120 and IN235120 hinges.

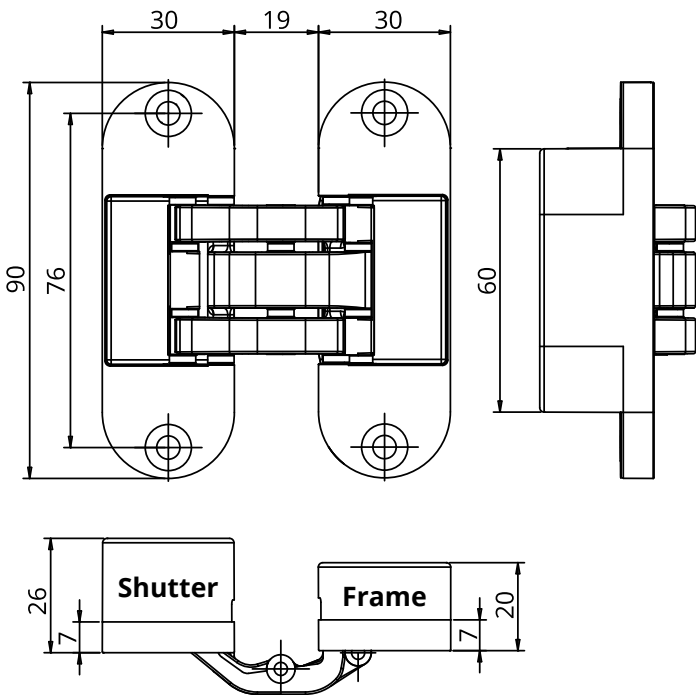

Technical data

Capacity*	40 Kg.
Hinge height	90 mm
Width shutter side	30 mm
Width frame side	30 mm
Depth shutter side	30 mm
Depth frame side	21 mm
Door opening angle	180°

\* Tested with 90x210 cm doors - For more information on the number of hinges to be used according to the weight and dimension of the door, please see the loading charts available on the website [www.otlav.it](http://www.otlav.it).

Finishing



IN301090V702  
Satinized silver plated

Technical features

- A **21 mm depth slot** on the frame side makes it unique and enables its perfect integration in reduced spaces. No need to cut the architrave which can be flush mounted.
- Material of hinge: ZAMAK.
- The hinge is reversible, if mounted in the center of the door thickness, allows the **reversibility of the door**, thus enabling the optimization of the stock and logistics at installation.
- Movement on **7 junction fulcrums** equipped with bearing in plastic HT with high resistance and long life.
- Outer casings protect the inner junction fulcrums against rubble coming from door installation works.
- The clamping screws, placed in the outer casings, are not used for hinge adjustment, therefore they remain stable for a long time.



# CI335150N035 plate hinge for 40 kg. doors

# Accessories

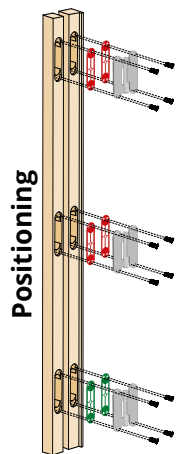
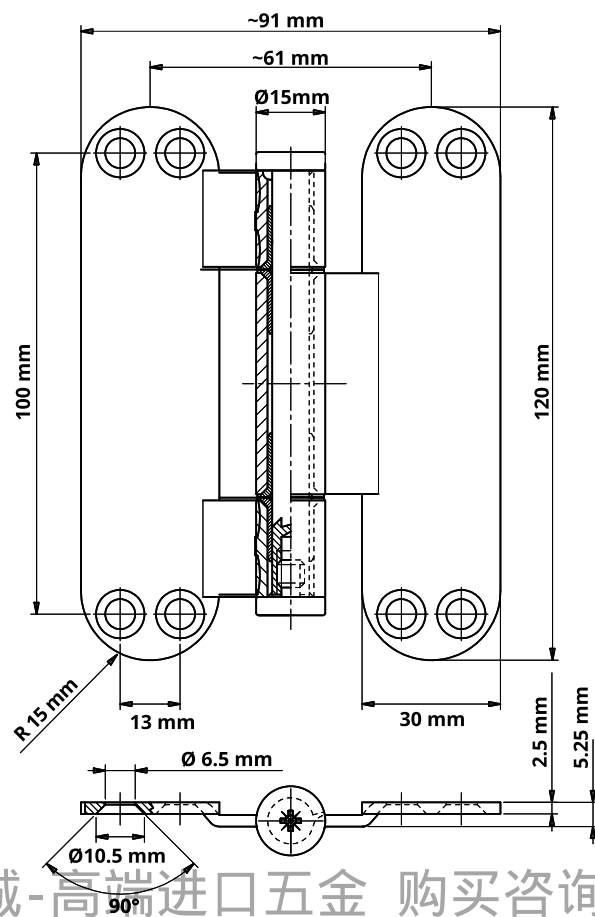
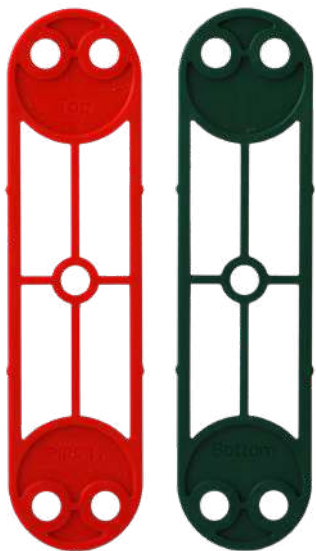
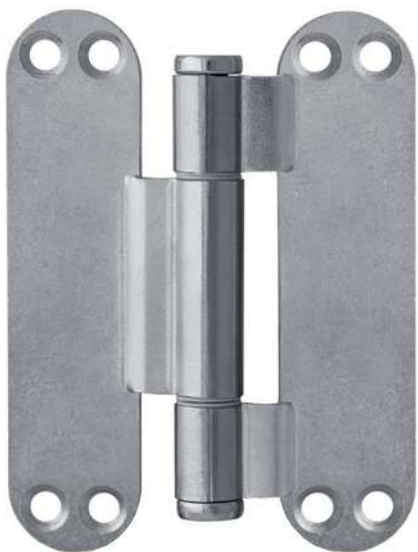

## Technical features

- The hinge is suitable to be installed on doors and frames with IN300, IN303 and IN305 millings.
- The hinge can be fitted right and left.
- Equipped with spacers that allows to prevent the natural sinking of the door.
- Kit composed by: 3 hinges, 4 green spacer, 4 red spacer and 24 screws

## Technical data

Capacity\* 40 Kg.

\* Tested with 90x210 cm doors - For more information on the number of hinges to be used according to the weight and dimension of the door, please see the loading charts available on the website [www.otlav.it](http://www.otlav.it).

## Finishing

Nickel plated

## Plate



**JC522**  
Fixing plate for IN310



**NP120040H502**  
Plate for IN300, IN303 and IN305 hinges



**NP120040H504**  
Plate for IN230 and IN235 hinges

**PP02**  
Shim to set up the plate NP120

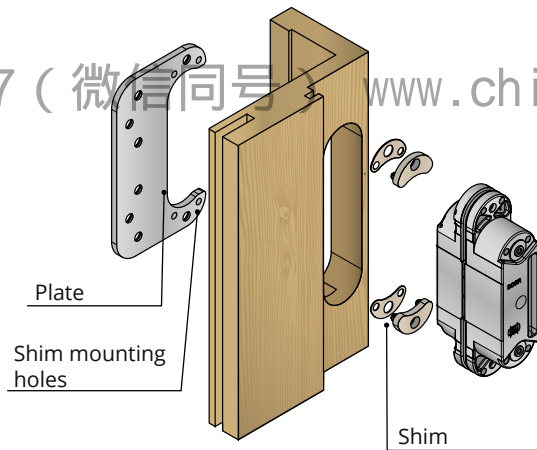

## Jigs



**MU230120G002**  
Aluminium jig for IN230, IN232 and IN235 hinges

**MU300120G002**  
Aluminium jig for IN300 and IN303 hinges

**MU310190G002**  
Aluminium jig for IN310 hinges

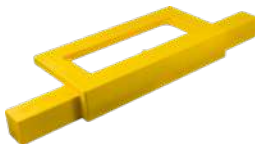

**MUINV500G004**  
Nylon jig for IN230, IN232 and IN235 hinges

**MUINV500G002**  
Nylon jig for IN300 and IN303 hinges

**MUINV500G006**  
Nylon jig for IN310 hinges

## Wedge



**PP105050Y202**  
Wedge with 5 spacers

## Tappo



**TP230120Z002**  
Nylon cap for IN230, IN235 and IN232 hole

# Adjustable door alignment device

- The device allows to keep the shutter aligned to the frame, avoiding in this way door deformities.
- Equipped with adjustable tension of the door jamb.
- Aluminum caps available to conceal the screws.

## AI300 Compatible with millings of IN300, IN305 and IN303 hinges

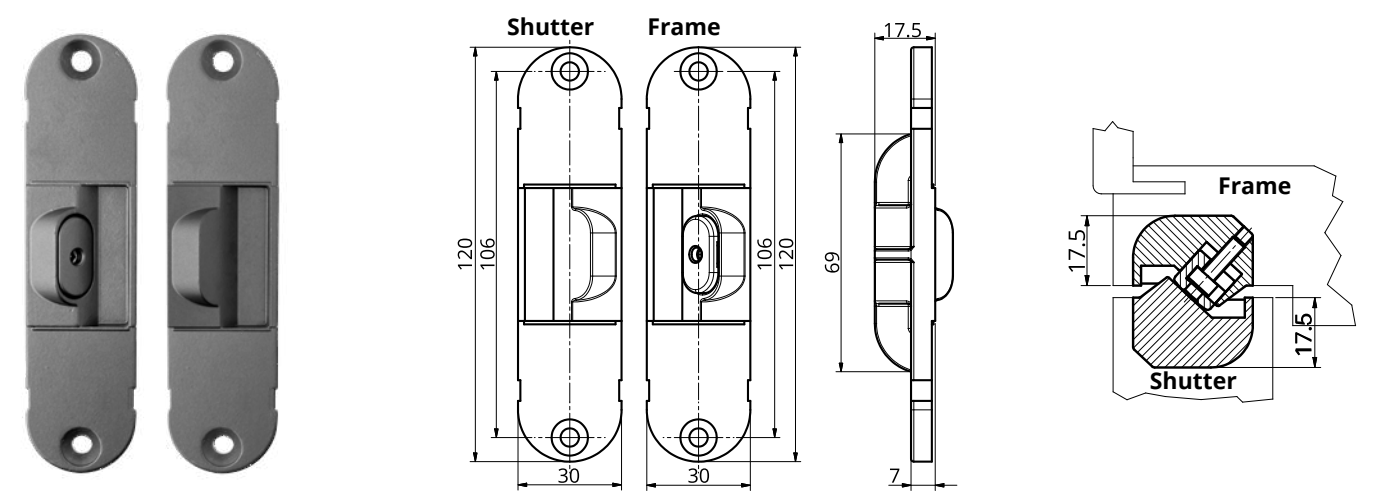

中意信诚-高端进口五金 购买咨询：13910114747（微信同号） [www.china-era.co](http://www.china-era.co)

## AI230 Compatible with millings of IN230 and IN235 hinges

