

CIR

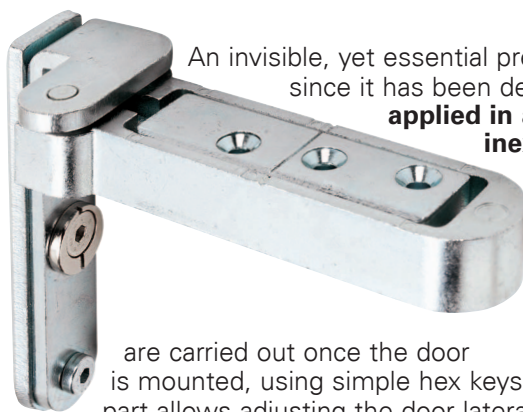

CIR *invisible to the eye, but its technical presence does not go unnoticed. This hinge emphasises SFS intec's manufacturing capability of making simple products complex.*



An invisible, yet essential presence, since it has been designed to be **applied in a simple and inexpensive way** on both right and left-handed doors.

Adjustments are carried out once the door is mounted, using simple hex keys. The sash part allows adjusting the door laterally up to $\pm 3.0\text{mm}$, whereas the frame part allows adjusting the depth by $\pm 1.5\text{mm}$.

The rotation fulcrum consists of a steel pin covered with a self-lubricating material, which ensures sliding and prevents squeaks and maintenance over time.

CIR is a full system. Besides the hinge, we provide embellishing cover caps, available in various colours, which can be applied inside the jamb, and the milling template.

Technically reliable, this new invisible hinge has been tested in 200,000 cycles with a 70 kg door.

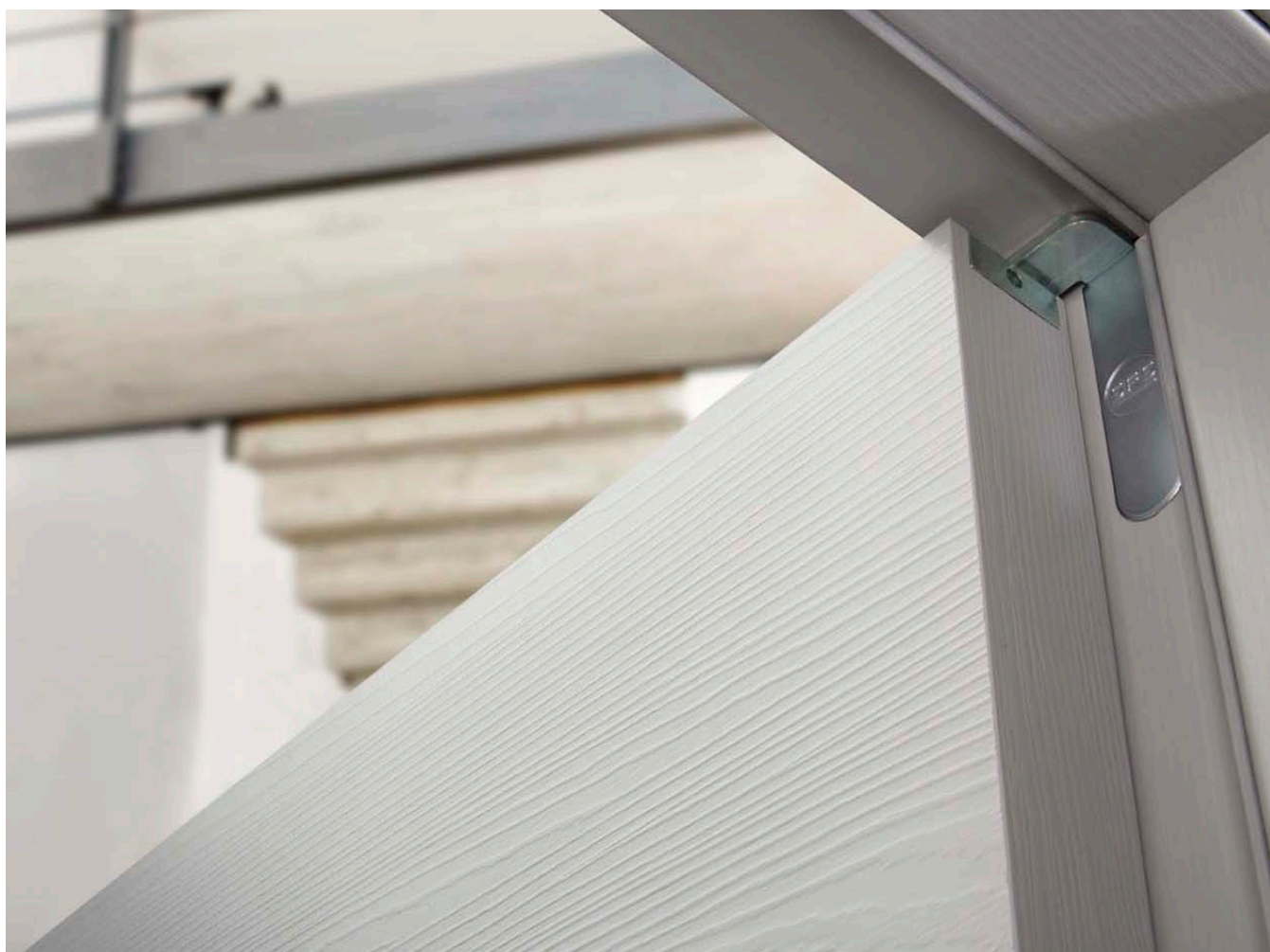

Technical data CIR

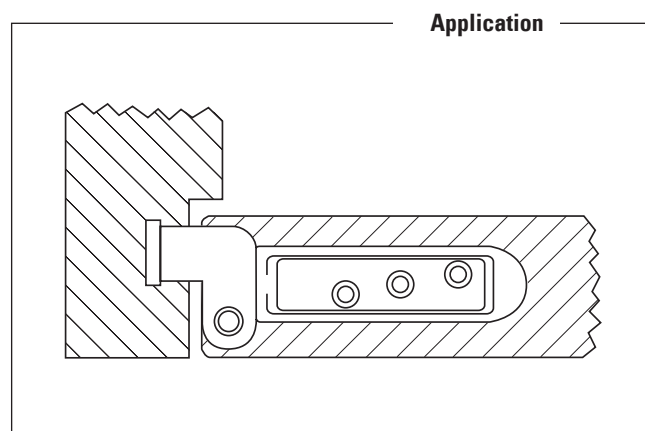
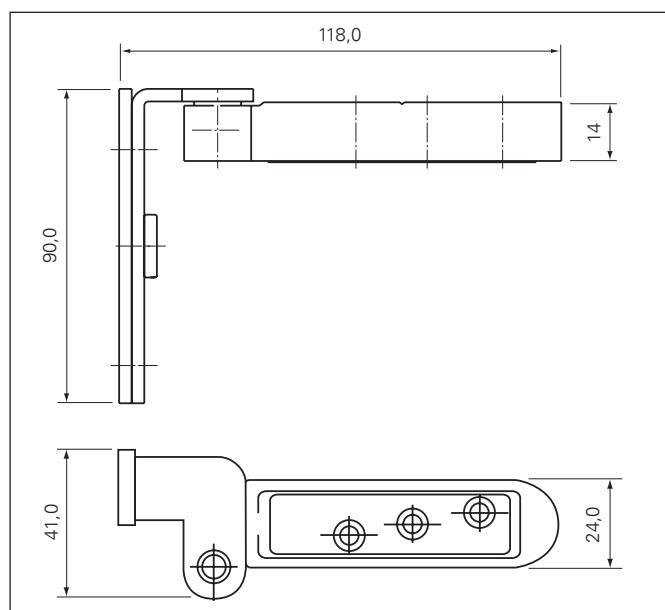

Adjustment instructions

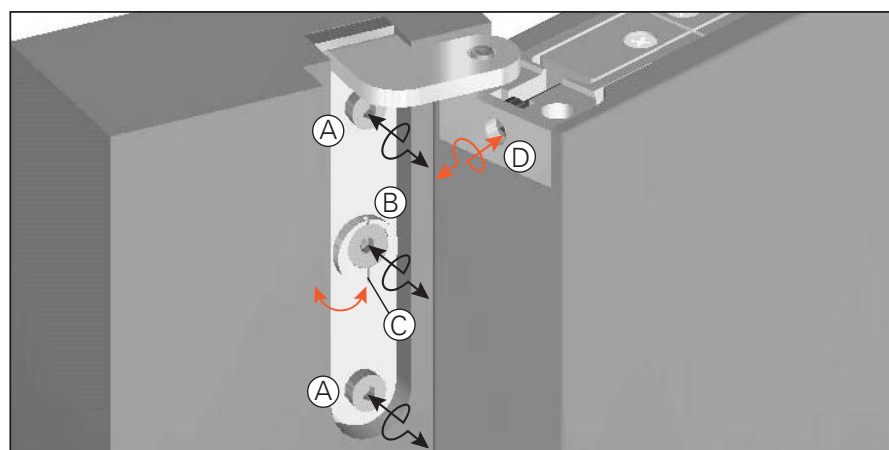

Depth adjustment

Loosen screws (A) and (B) and adjust eccentric screw (C) to adjust depth.

Lateral adjustment

Adjust screw (D)

Milling diagrams

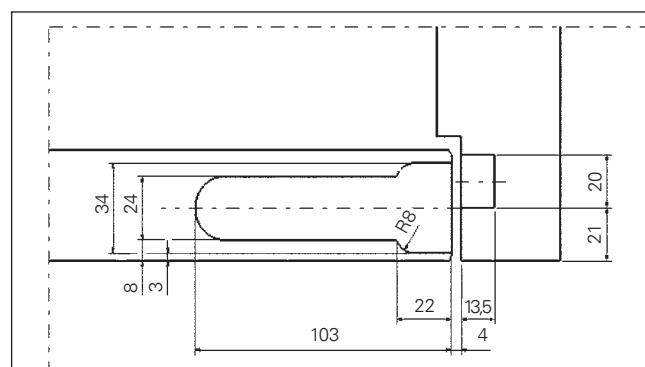
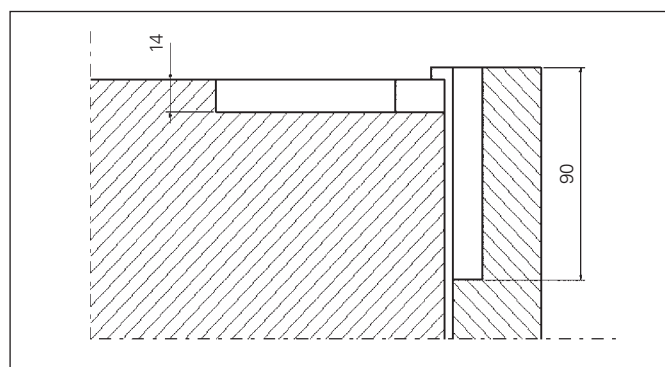

Finishes and codes

	Ordering codes	Finish	Packaging
Hinge	1272272	Zinc	6 pairs

drawings available in .dxf format upon request

* 1 pair = 1 door