



Lighting

COLLECTION

ROCKY MOUNTAIN®
H A R D W A R E

Known for Creating Fine Architectural Hardware,

Rocky Mountain also offers a complete Lighting Collection. Combining the warm texture of cast art-grade bronze with hand crafted glass, this collection is designed to gracefully span styles from contemporary to traditional. Whether used on their own, or to complement other Rocky Mountain Hardware products, these fixtures will make the perfect statement of elegance.

- 3 Green Philosophy
- 4 Lighting Options
- 6 Wall Sconces
- 10 Plank Sconces
- 12 Mod & Vessel Sconces
- 16 Pendants
- 20 Vanity Lights
- 22 Chandeliers



Front Cover
Alpha Pendants shown in silicon bronze, dark patina—PE455

- Charlie Pendants—PE435
- Wall Mount Faucet with Mini French levers—WMF with LW20
- Cirque sink—SK218
- Decora Switchplate—DSP1
- All shown in silicon bronze, brushed patina

- Truss Sconce shown in white bronze, brushed patina with black leather—WS416 with G153 escutcheon





- Vessel Sconce shown in silicon bronze, brushed patina—WS430
- Delta Pendants shown in silicon bronze, brushed patina—PE430

At Rocky Mountain Hardware we believe

that being environmentally responsible is part of our job. We are committed to developing sustainable business practices by making changes for the better—continuing to improve our products, our facilities and our processes.

Rocky Mountain Hardware is a family owned and operated business, with all of our manufacturing taking place in our home state of Idaho. We are based here because we appreciate our remarkable surroundings: endless mountain ranges, alpine lakes and crisp, clean air. We take our responsibility to reduce our impact on the environment seriously. It's simply the right thing to do.

We are dedicated to the use of recycled bronze to create all of our products. Please visit our website to learn more about our certifications and how our products can contribute towards earning up to two USGBC LEED® points.

Wall SCONCES

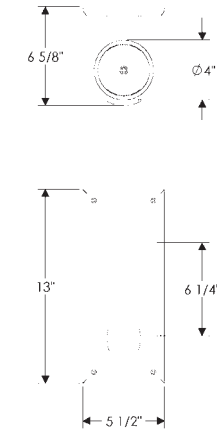

POST SCONCE
WS400
Weight: 11 lbs.
Shown with the G4513 5 1/2" x 13" rectangular
escutcheon in white bronze, dark patina.

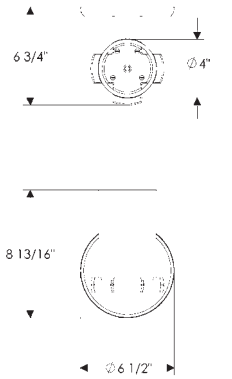

TRUSS SCONCE
WS410
Weight: 11 lbs.
Shown with the E419 6 1/2" round escutcheon
in silicon bronze, brushed patina.

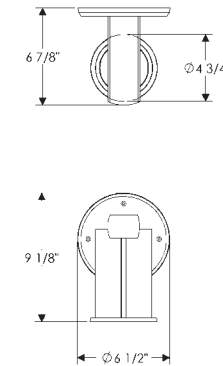

POST SCONCE
WS405
Weight: 11 lbs.
Shown with the E419 6 1/2" round
escutcheon in silicon bronze, medium patina.

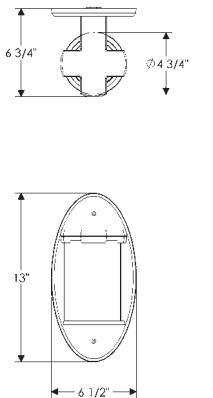

TRUSS SCONCE
WS415
Weight: 11 lbs.
Shown with the E560 6 1/2" x 13" oval
escutcheon in white bronze, dark patina.

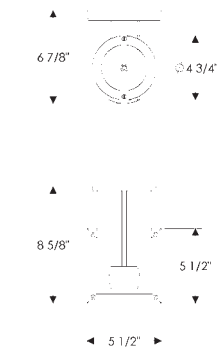

POST SCONCE
WS405
Weight: 11 lbs.
Shown with the E155 5 1/2" square designer
escutcheon in silicon bronze, light patina, and
wine leather.

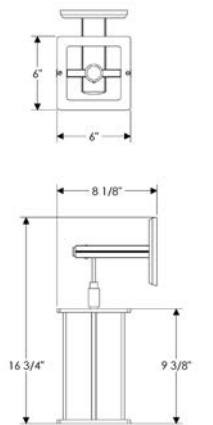

ECHO PENDANT-RING SCONCE
WS590
Weight: 13 lbs.
Shown with the E155 5 1/2" square Designer
escutcheon in white bronze, light patina and
hazel leather.

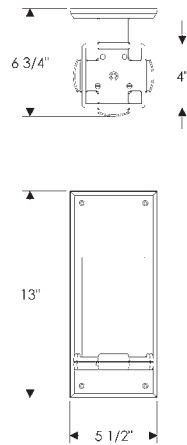

TRUSS SCONCE
WS416
Weight: 11 lbs.
Shown with the G4513 5 1/2" x 13" rectangular
escutcheon in white bronze, light patina.

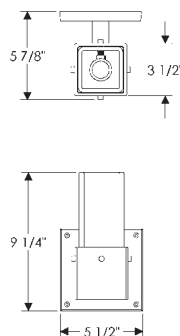

CHARLIE SCONCE
WS419
Weight: 6 lbs.
Shown with the E280 5 1/2" square Metro
escutcheon in silicon bronze, dark lustre.

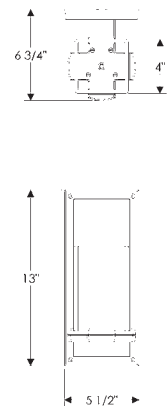

TRUSS SCONCE
WS416
Weight: 11 lbs.
Shown with the G153 5 1/2" x 13" rectangular
designer escutcheon in white bronze,
brushed patina, and white leather.

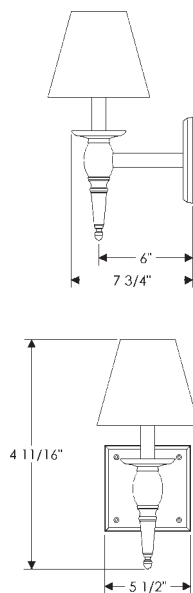

TOWNE SCONCE
WS500
Weight: 6 1/2 lbs.
Shown with the E403 5 1/2" square escutcheon
in silicon bronze, light patina. Fabric shade
options, crystals, and prism are available as
shown. See rockymountainhardware.com.

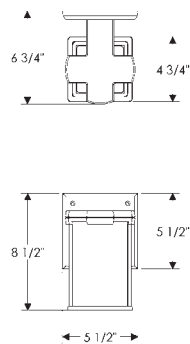

TRUSS SCONCE
WS418
Weight: 11 lbs.
Shown with the E403 5 1/2" square
escutcheon in silicon bronze, dark patina.

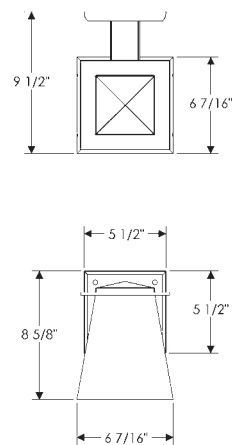

LANTERN SCONCE
WS465
Weight: 27 lbs.
Shown with the E403 5 1/2" square
escutcheon in silicon bronze, dark patina.
UL rated for wet location.

- Truss Sconces—WS418 with E403 escutcheon
Wall Mount Faucet on Rectangular escutcheon
with Pool levers—WMF, E465 with L310
Quadra sink—SK422
Rail Towel Bar—TB5
Bronze and glass vanity—BV1
All shown in silicon bronze, brushed patina





• Plank Sconce—Flat Glass shown in white bronze, medium patina—WS440

Plank sconces



PLANK SCONCE—FLAT GLASS
WS440
Weight: 22 lbs.
Shown in silicon bronze, rust patina.

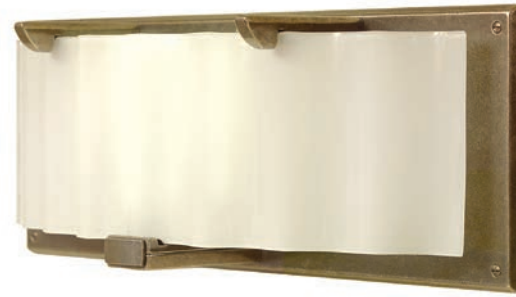
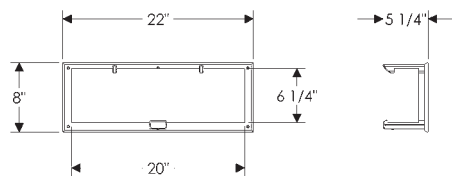

PLANK SCONCE—CORRUGATED GLASS
WS445
Weight: 22 lbs.
Shown in white bronze, medium patina.

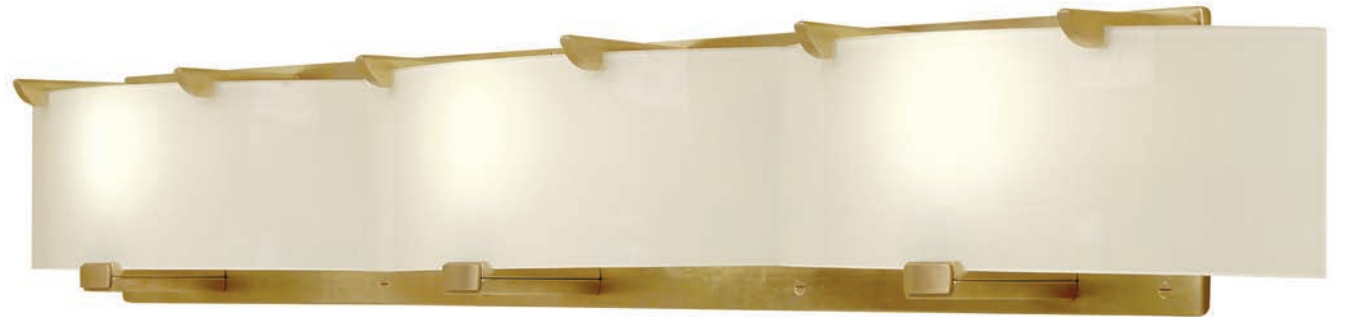
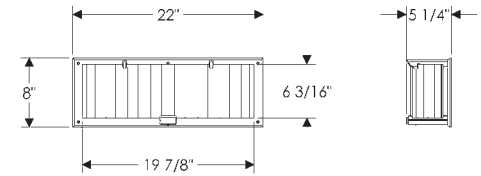

TRIPLE PLANK SCONCE—FLAT GLASS
V440
Weight: 60 lbs.
Shown in silicon bronze, brushed patina.

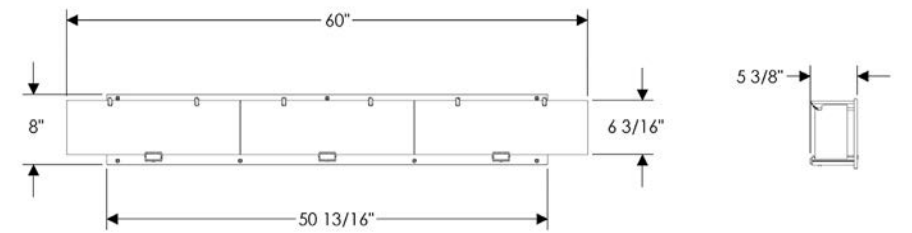

TRIPLE PLANK SCONCE—CORRUGATED GLASS
V445
Weight: 60 lbs.
Shown in white bronze, dark patina.

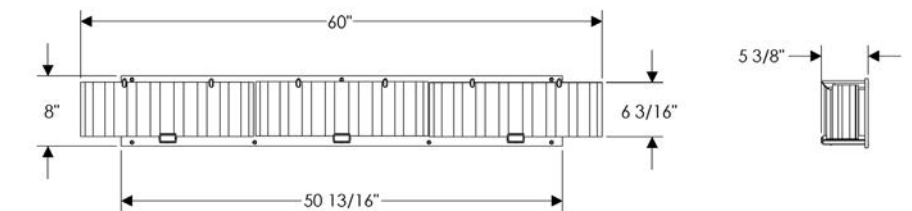



Mod SCONCES

MOD SCONCE
WS421
Weight: 14 lbs.
Shown with the G504 2 3/4" x 19 7/8" curved escutcheon
in white bronze, light patina (bulb included).

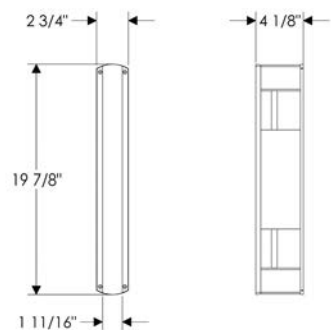

MOD SCONCE
WS421
Weight: 18 lbs.
Shown with the G520 5" x 19 7/8" curved escutcheon
in white bronze, dark patina (bulb included).

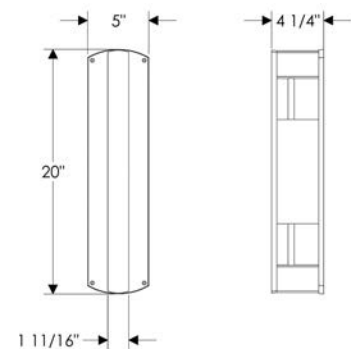

Vessel SCONCES

SMALL VESSEL SCONCE
WS425
Weight: 30 lbs.
Shown in white bronze, dark patina.

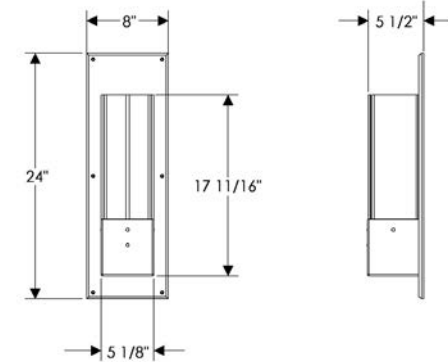

VESSEL SCONCE
WS430
Weight: 85 lbs.
Shown in silicon bronze, light patina.

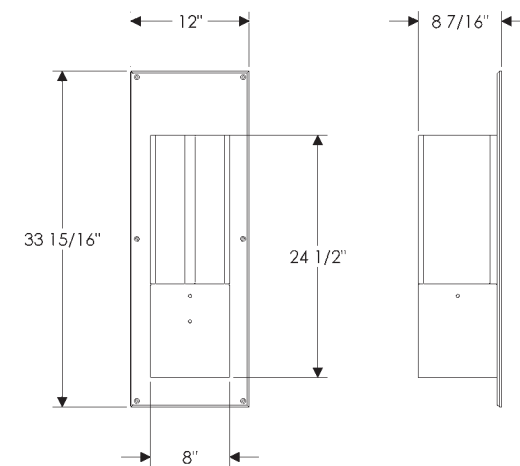

TUNNEL SCONCE
 WS480
 Weight: 18 lbs.
 Shown in white bronze, medium patina.

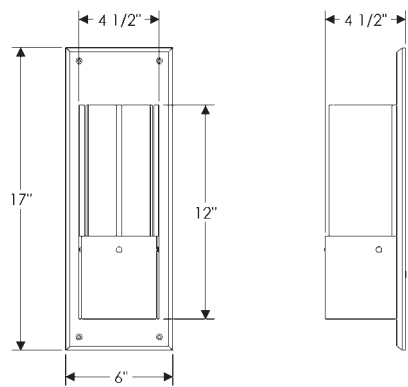

DOUBLE TUNNEL SCONCE
 WS420
 Weight: 25 lbs.
 Shown in silicon bronze, dark lustre patina.

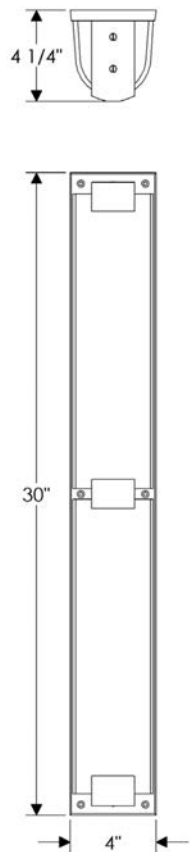

DOUBLE CHARLIE SCONCE
 WS423
 Weight: 18 lbs.
 Shown in white bronze, brushed patina with
 silicon bronze, dark lustre patina.

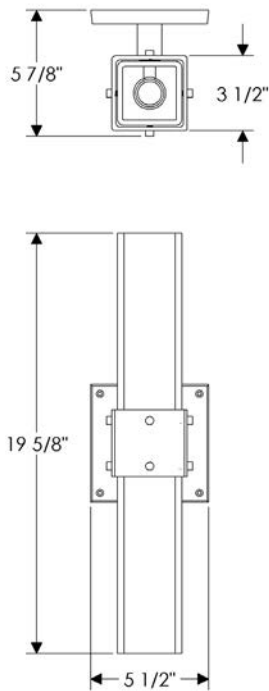

• Double Charlie Sconce shown in white bronze, brushed
 patina with silicon bronze, dark lustre patina-WS423



Pendants

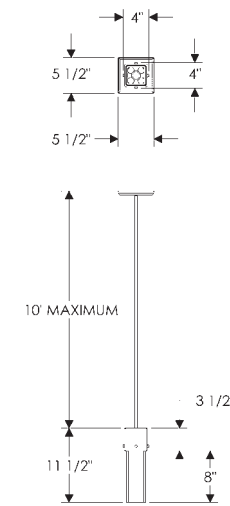

CHARLIE PENDANT
PE435
Weight: 5 lbs.
Shown with the E403 5 1/2" square ceiling
escutcheon in silicon bronze, brushed patina.

Specify desired length from ceiling to bottom of fixture.

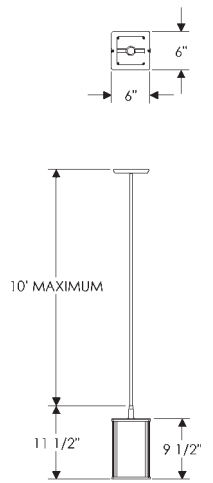

ECHO PENDANT
PE465
Weight: 7 lbs.
Shown with the E419 6 1/2" round ceiling
escutcheon in white bronze, light patina.

Specify desired length from ceiling to bottom of fixture.

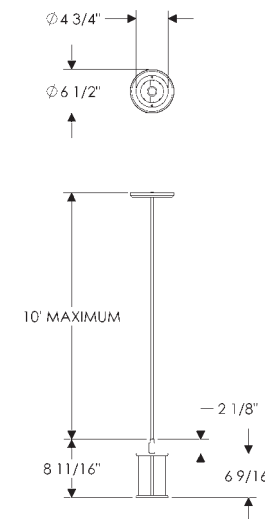

BRAVO PENDANT
PE450
Weight: 3 1/2 lbs.
Shown with the E419 6 1/2" round ceiling
escutcheon in white bronze, light patina.

Specify desired length from ceiling to bottom of fixture.

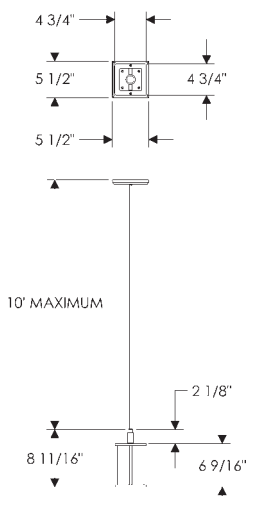

ALPHA PENDANT
PE455
Weight: 3 1/2 lbs.
Shown with the E403 5 1/2" square ceiling
escutcheon in silicon bronze, rust patina.

Specify desired length from ceiling to bottom of fixture.

Charlie Pendants—PE435
Wall Mount Faucet on Designer Collection escutcheon with
Reed levers and brown weave leather—WMF, G133 w/ L304
Towel Ring on Designer Collection escutcheon with brown
weave leather—TR6, E103
All shown in white bronze, light patina

DELTA PENDANT
PE430
Weight: 40 lbs.
Shown in silicon bronze, brushed patina.

Specify desired length from ceiling
to bottom of fixture.

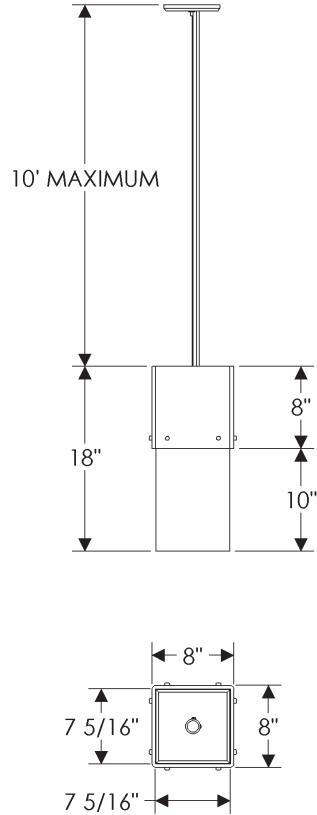

CARGO PENDANT
PE530
Weight: 85 lbs.
Shown in silicon bronze, light patina.

Specify desired length from ceiling
to bottom of fixture.

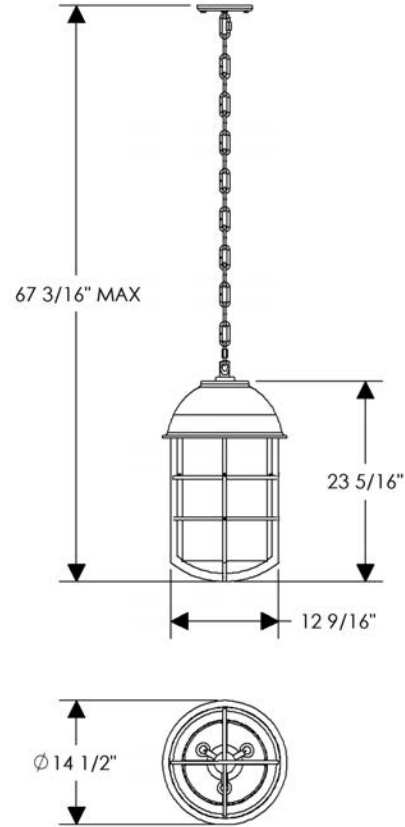

• Cargo Pendant shown in silicon bronze, light patina--PE530



• Lantern Vanity Light--V450-26 Shown in silicon bronze, dark patina

Vanity LIGHTS

LANTERN VANITY
V455-26
Weight: 21 lbs.
Shown with E403
5 1/2" square escutcheon
in silicon bronze, dark patina.



V450-26 round glass
V455-26 square glass
21 lbs.

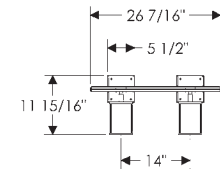

V450-40 round glass
V455-40 square glass
27 lbs.

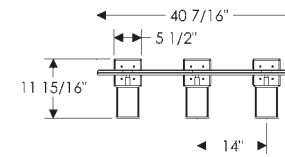

V450-54 round glass
V455-54 square glass
34 lbs.

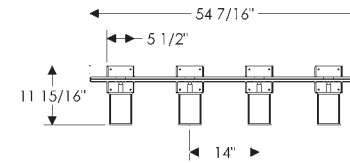

V450-68 round glass
V455-68 square glass
40 lbs.

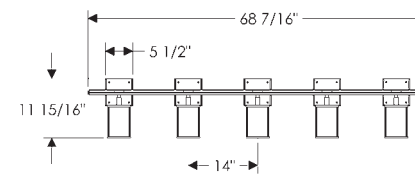

V450-82 round glass
V455-82 square glass
45 lbs.

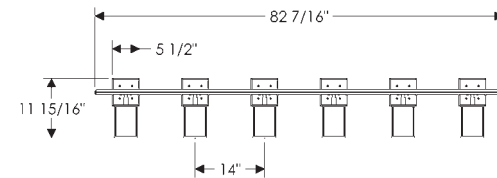

V450-94 round glass
V455-94 square glass
50 lbs.

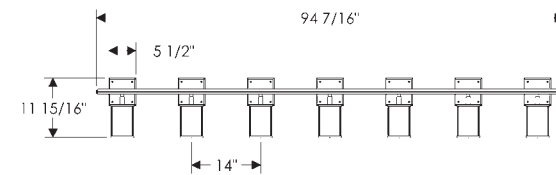

LANTERN VANITY
V450-68
Weight: 40 lbs.
Shown with E403
5 1/2" square escutcheon
in silicon bronze, light patina.



CROSS ARM CHANDELIER-SQUARE GLASS
C455
Weight: 50 lbs.
Shown in silicon bronze, rust patina with the
G4513 5 1/2" x 13" rectangular ceiling escutcheon.

Specify desired length from ceiling to bottom of fixture.

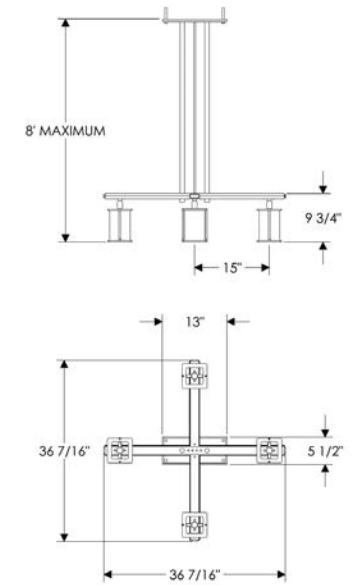
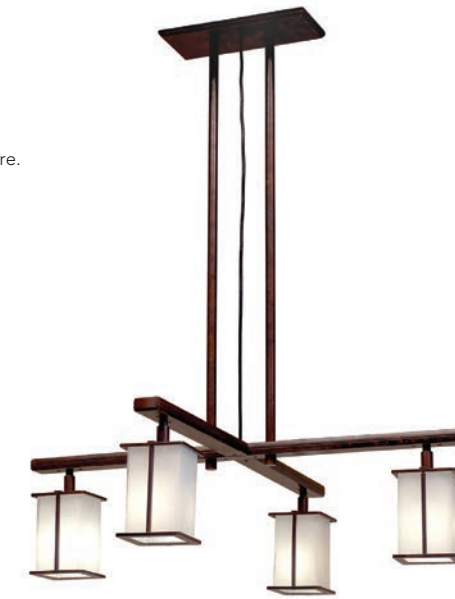

Chandeliers

CROSS ARM CHANDELIER-ROUND GLASS
C450
Weight: 50 lbs.
Shown in white bronze, medium patina with the
G4513 5 1/2" x 13" rectangular ceiling escutcheon.

Specify desired length from ceiling to bottom of fixture.

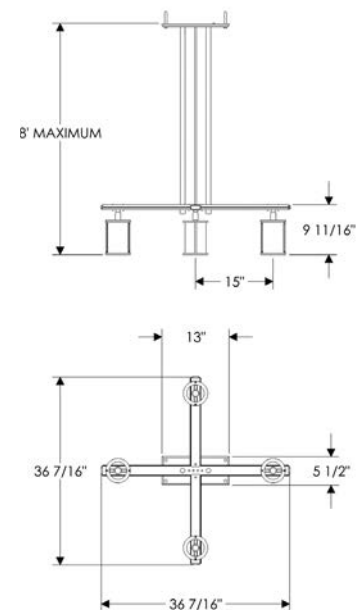
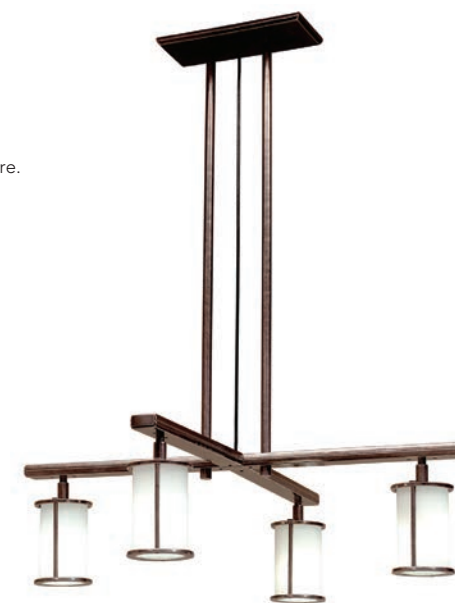

CUBE CHANDELIER—CORRUGATED GLASS
C400CB
Weight: 44 lbs.
Shown in silicon bronze, dark patina with the
G4513 5 1/2" x 13" rectangular ceiling escutcheon.

Specify desired length from ceiling to bottom of fixture.

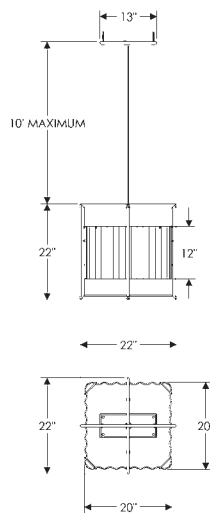

CUBE CHANDELIER—FLAT GLASS
C400FB
Weight: 44 lbs.
Shown in white bronze, light patina with the
G4513 5 1/2" x 13" rectangular ceiling escutcheon.

Specify desired length from ceiling to bottom of fixture.

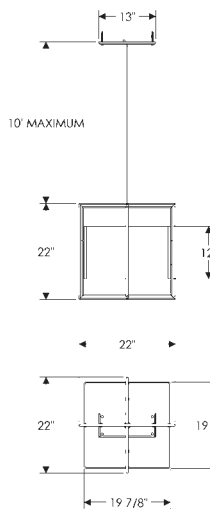

DOUBLE CUBE CHANDELIER—FLAT GLASS
C405FB
Weight: 85 lbs.
Shown in white bronze, light patina with the
G4513 5 1/2" x 13" rectangular ceiling escutcheon.

Specify desired length from ceiling to bottom of fixture.

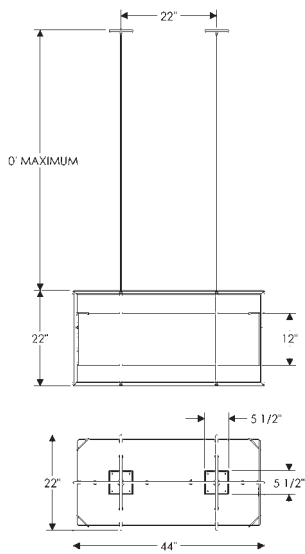



• Linear Chandeir shown in silicon bronze, light patina--C420



TOWNE 3-ARM CHANDELIER
C525
Weight: 33 lbs.
Shown in silicon bronze, dark patina. Fabric shade options, crystals, and prism are available as shown. See rockymountainhardware.com. Maxiumum standard length is 73".



TOWNE 5-ARM CHANDELIER
C500
Weight: 46 lbs.
Shown in white bronze, light patina. Fabric shade options, crystals, and prism are available as shown. See rockymountainhardware.com. Maxiumum standard length is 73".



LINEAR CHANDELIER
C420
Weight: 65 lbs.
Shown in silicon bronze, light patina. Maximum standard length is 10".

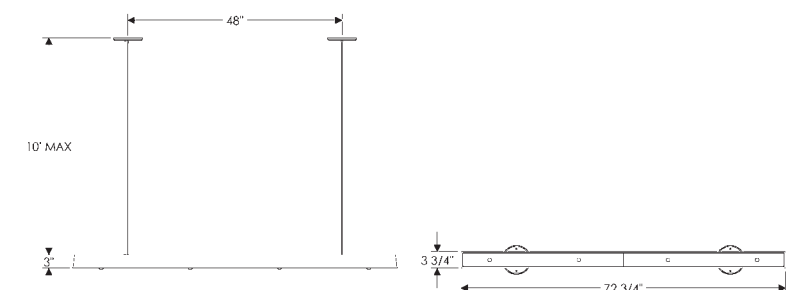



ROCKY MOUNTAIN®

H A R D W A R E

1020 Airport Way Post Office Box 4108 Hailey, Idaho 83333
Toll-free 888.788.2013 Fax 208.788.2577
info@rockymountainhardware.com
rockymountainhardware.com

北京中意信诚贸易有限公司
T +86 13910114747
[Http://www.china-era.com](http://www.china-era.com)

We also offer a complete line of door hardware, accessories, sinks, faucets, and more to complement this collection. Visit our website to see more.